

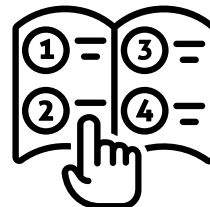

bulcan



USERS MANUAL ALL DEVICES



Compatibility

Bulcan version 1.0 offers data to all devices with EBIKE fields.

Your Device

Below we are going to show you an example of pairing.

You will have to go to the instructions for your device where you will find all the instructions on how to pair with sensors.

STEP 1

Turn On your ebike.

Turn on the ebike with the bulcan correctly installed according to the Installation Guide.



STEP 2

Pairing 1.

According to the instructions of your device, search for sensors.

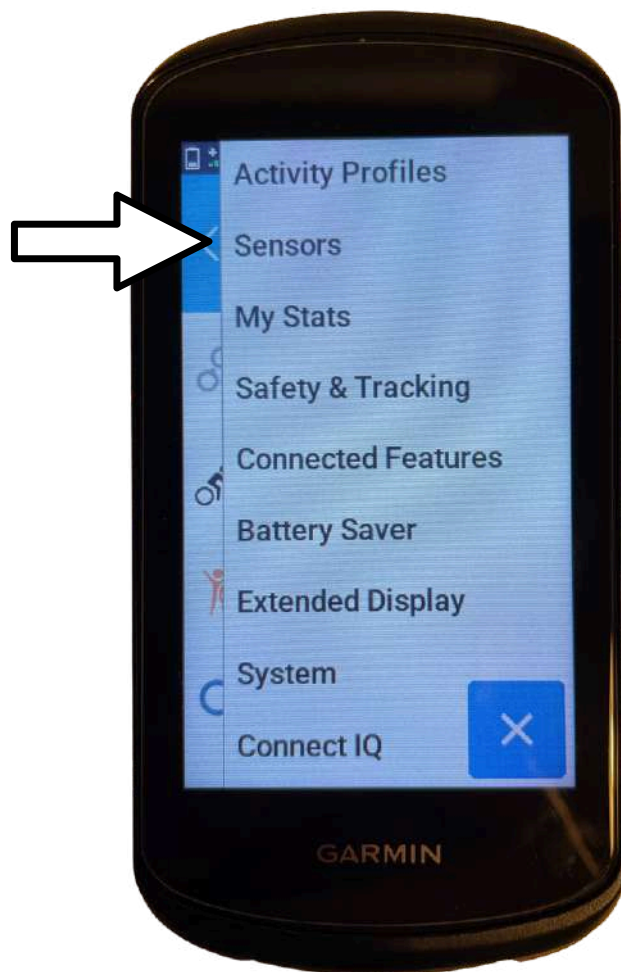

STEP 3

Pairing 2.

Select the sensors you want to connect to.

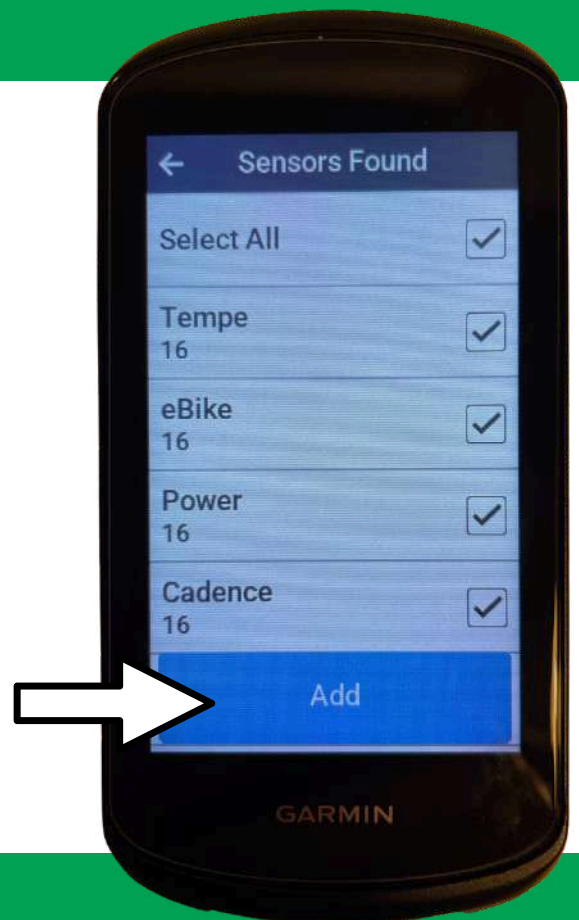

STEP 4

Connected!.

From this moment your device is connected to the selected sensors and they will be displayed according to the instructions of your device.

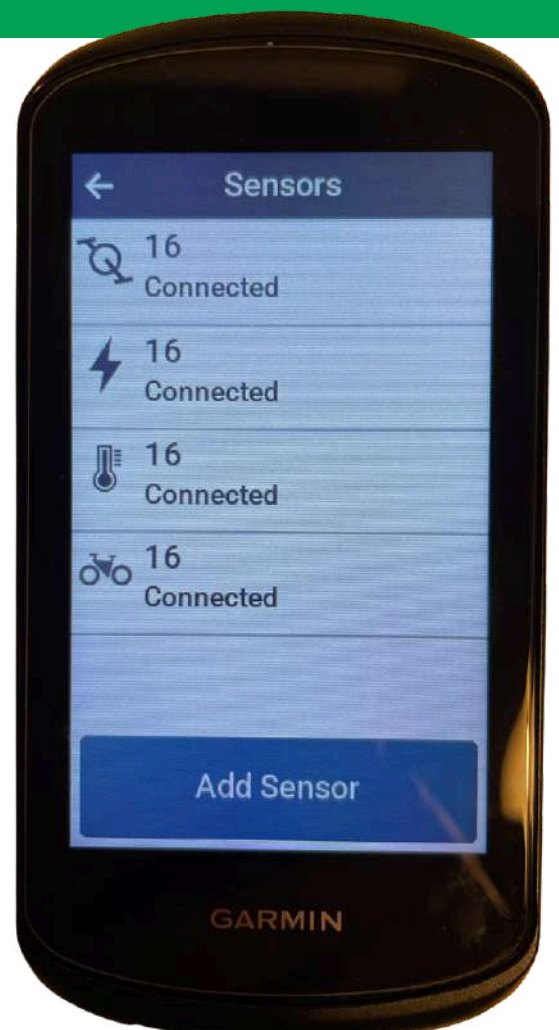

STEP 5

Pairing remote control on Garmin:

IMPORTANT: Before pairing the remote control, it is necessary to pair the Ebike sensor described in the previous steps.

To install the page turn remote on Garmin simply search for the EDGE REMOTE sensor and add it.

From that moment on, the ebike's "walk" button will act as a page forward on compatible Garmin devices.
(you have to wait 4 seconds between each page turn)

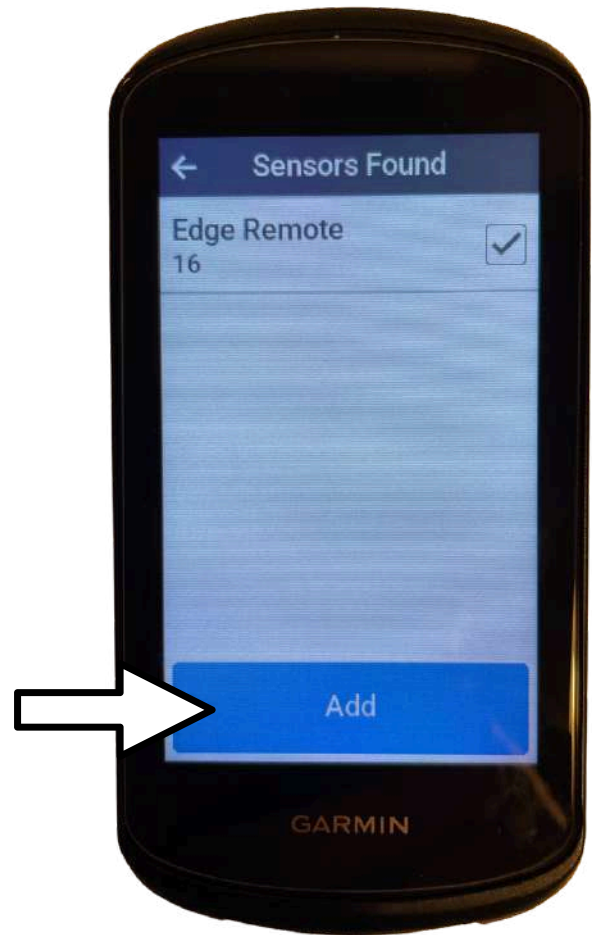

Data sent by Bulcan:

Assistance mode:

The assistance mode is sent by the Ebike sensor, it is always displayed on a scale of 7 values:

Off -> Level 0
Eco -> Level 1
Tour -> Level 3
eMTB -> Level 5
Turbo -> Level 7

Speed:

Ebike speed.

Km:

Total km of the ebike.

Remaining km (range):

estimate of the km you can travel based on the remaining battery and the selected mode (Range).



by lab.bike

Remaining battery:

Remaining battery percentage.

Assistance:

Percentage of power being delivered by the cyclist and the engine.

Important: Since Garmin does not have a specific field for assistance percentage, it will be displayed in the “balance” field, with the left leg being the percentage contributed by the cyclist and the right leg being the percentage contributed by the motor.

Battery voltage:

This field cannot be added to a device screen, it appears in the “sensor details” section.

Power:

Power in kW, extracted from the engine power sensor.

Cadence:

Cadence.

It can be extracted from the Power sensor (recommended), in case your device does not have a power sensor, we can extract it from the cadence sensor.



by lab.bike

Engine/battery temperature:

Bulcan sends the temperature from both its EBIKE sensor and its TEMPERATURE sensor.

Engine temperature from EBIKE sensor:

Engine temperature, displayed as follows:

Cold | Cold/Warm | Warm | Warm/Hot | Hot

Engine/battery temperature from sensor TEMPERATURE:

Since there are no engine and battery temperature fields on the cycle computers, the temperature data from the temperature sensor will be displayed in the maximum/minimum temperature fields once the Bulcan temperature sensor is selected.

Maximum temperature of the last 24h: Engine temperature.

Minimum temperature of the last 24H: Battery temperature.



by lab.bike